

frogContact5-BAT

Multifunctional 5-channel battery powered contact module to query low-voltage contacts. Featuring integrated logic module with comfort and timer functions.

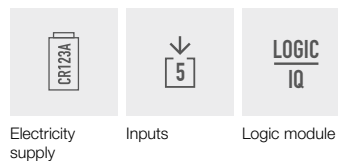
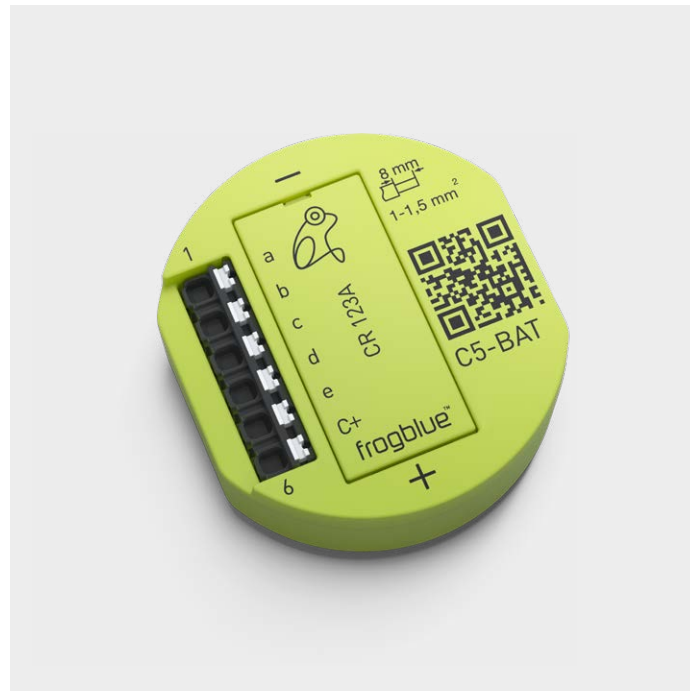

Technical Data

Category	
Article designation	frogContact5-BAT
Article number	C5-BAT.01
Assembly type	Recess-mounted (in device socket according to DIN 49073)

Functions and power

Inputs	5 (connection of potential-free contacts)
Outputs	–
Outputs can be dimmed	–
Minimum Load	–
Maximum Power per output	–
Suitable loads	–
Unsuitable loads	–
Output modes	–
Protection category	Conforms to IP20
Integrated logic module	Yes
Integrated configuration backup	–
Comfort and timer functions	Yes
Power measurement	–
Short circuit detection and notification	–

frogContact5-BAT

Dimensions and weight

Dimensions (L x W x H): 53 x 48 x 21 mm
Weight: 25 g

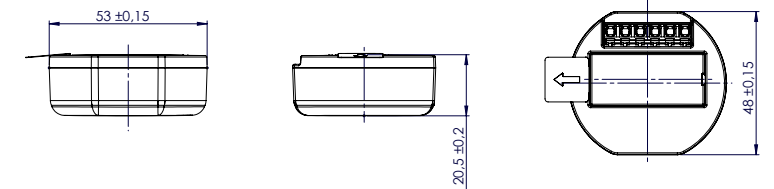

Connection example:

Socket depth min. 53 mm for installation behind switch insert
rec. 63 mm for installation behind switch insert

Individual installation is necessary for shallow depths.

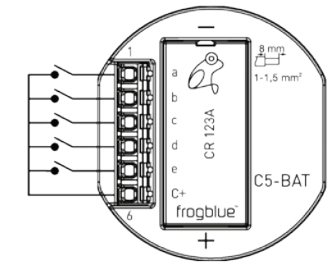

Battery

Type	CR123A
Number	1
Replaceable/exchangeable	Yes
Service life	Up to 10 years on stand-by, or up to 250,000 actuations

Network

WLAN	No
Bluetooth	Bluetooth 4.2 Low Energy
Frequency range	2400–2483.5 MHz maximum 3.4dBm
Typical radio open field range	30 metres

Operation and storage

Ambient temperature	-25 ° to +55 °C
Storage temperature	-25 ° to +60 °C
Air humidity (during operation)	(Non-condensing)

Power connection

Connection variants	Magnet contact, window contact, microswitch etc.
Connection type	Spring plug-in terminal
Wire cross section	1–1.5 mm ² (rigid conductor recommended)
Stripping length	8 mm
Wire length per input	max. 50 metres

Packaging

Packaging size	1 unit
EAN 1 unit	4260578530446
Packaging dimensions (L x W x H) 1 unit	75 x 30 x 75 mm
Weight including packaging 1 unit	70 g

frogblue_Data_EN_1-21_C5-BAT.01 01.21

Subject to change.
Electrical equipment may only be installed and fitted by qualified electricians.

For more information visit:
www.frogblue.com.

